

Plan View

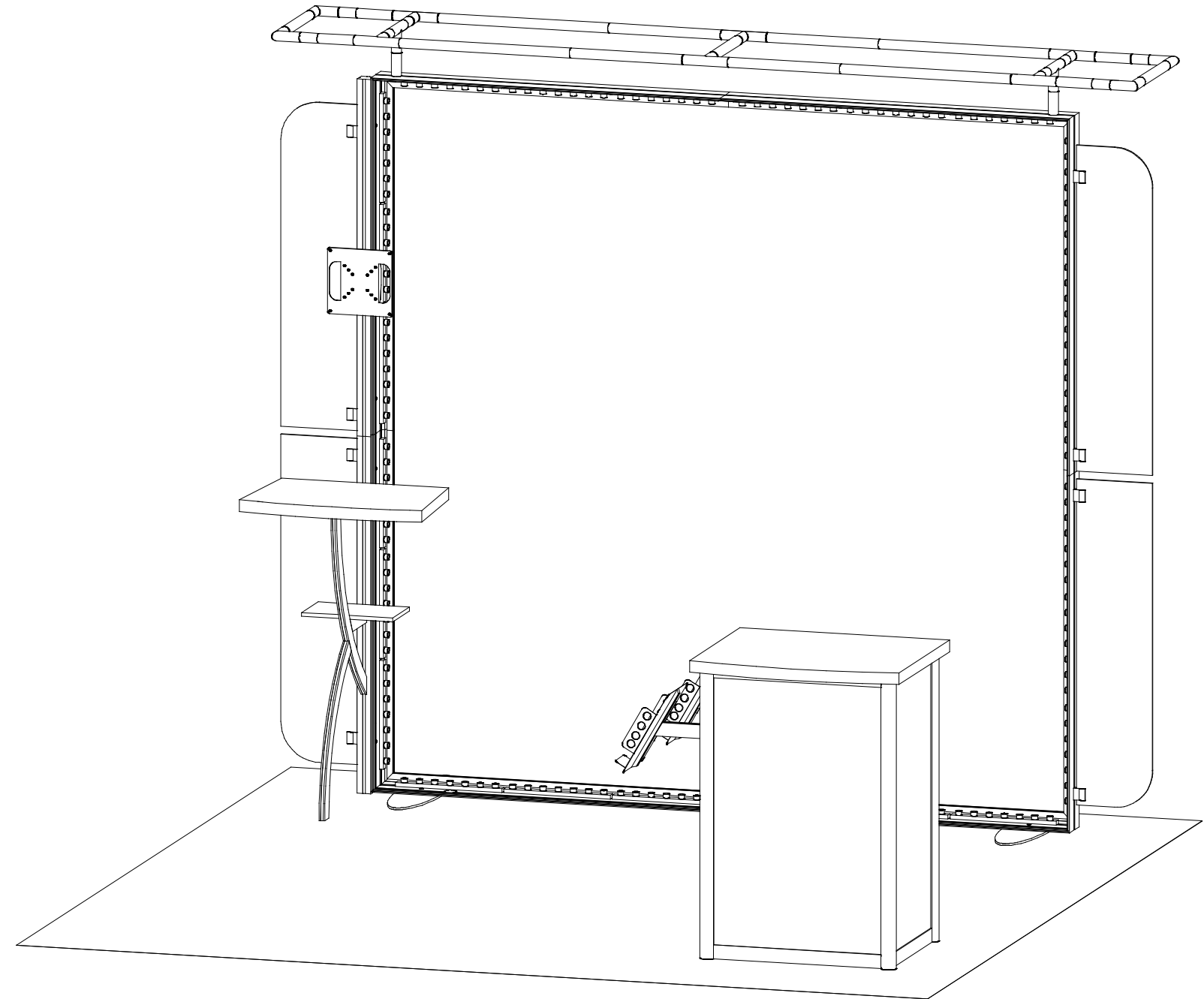

General Setup Instructions

- Read entire setup instruction manual prior to unpacking parts and pieces.
- The setup instructions are created specifically for this configuration.
- Setup instructions are laid out sequentially in steps, including exploded views with detailed explanation for assembly.

Cleaning & Packing

- For Cleaning Metal, Plex, & Laminate Parts: Use a **MILD NON-ABRASIVE** cleanser and soft cloth/paper towel to clean all surfaces.
- Keep exhibit components away from heat and prolonged sun exposure.
Heat and UV exposure will warp and fade components.
- Retain all provided Packing Materials. All provided packing materials are for ease of repacking & component protection.

Disassembly

- For loss prevention, tighten all setscrews and locks during disassembly

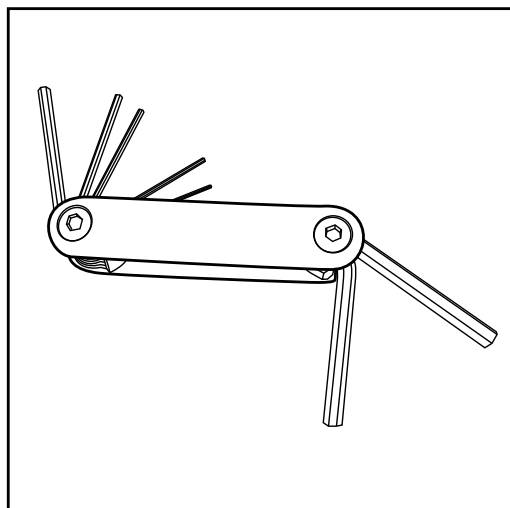

Hex Tool - Essential for Assembly

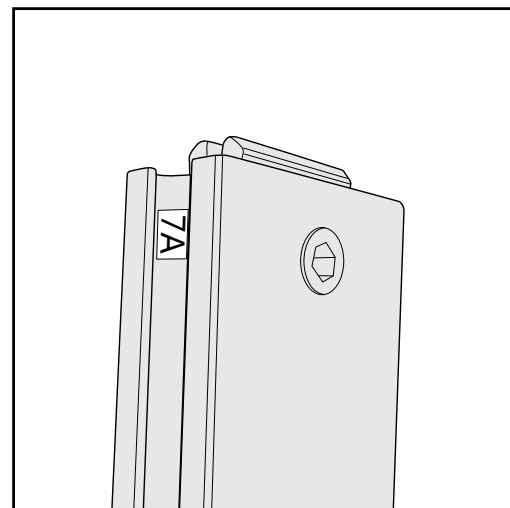

Part Identification - Numbering

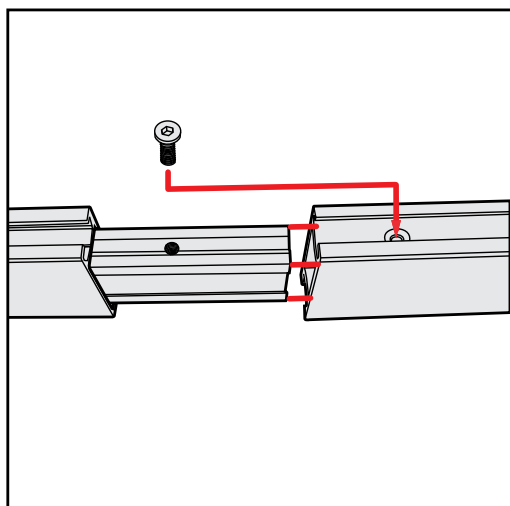

Spline Connection

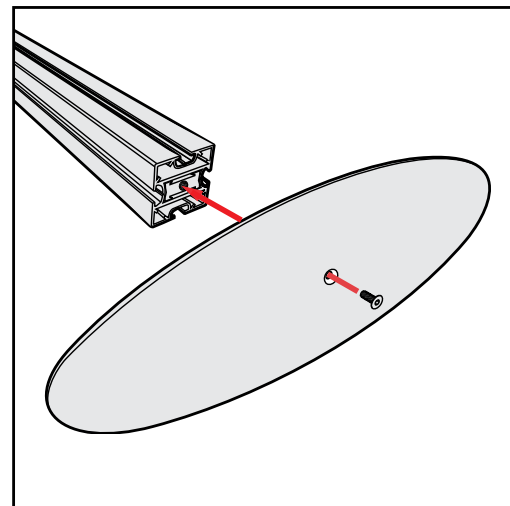

Base Plate & Extrusion Connection

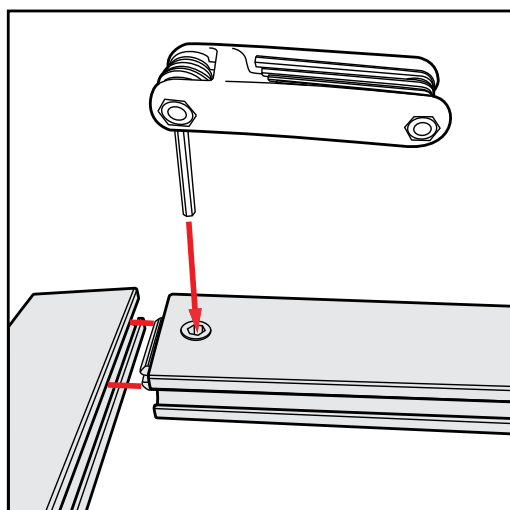

Extrusion & Lock Connection

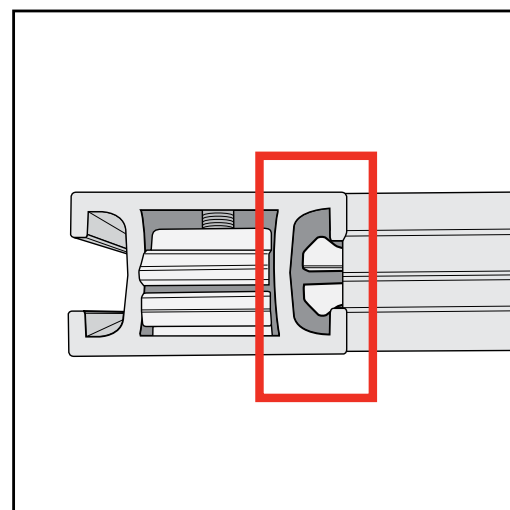

Engaged Lock



WARNING

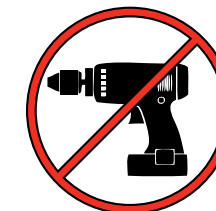

DO NOT USE POWER TOOLS



LADDERS OR LIFTS
MAY BE REQUIRED



ALL CONNECTIONS MUST
BE TIGHTLY SECURED

CEI-110 Frames Assembly

Straight Bracket Installation (when required)

- 1) Slide TWO-PIECE **TS RV 4** straight bracket into Interior Center Slot of extrusion so that two of the set screws are inside groove. Tighten two set screws to secure.
- 2) Slide connecting extrusion over exposed end of bracket. Tighten two remaining set screws to secure.

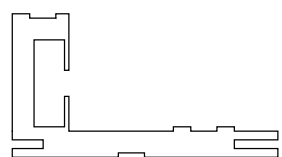

CEI-110 Profile

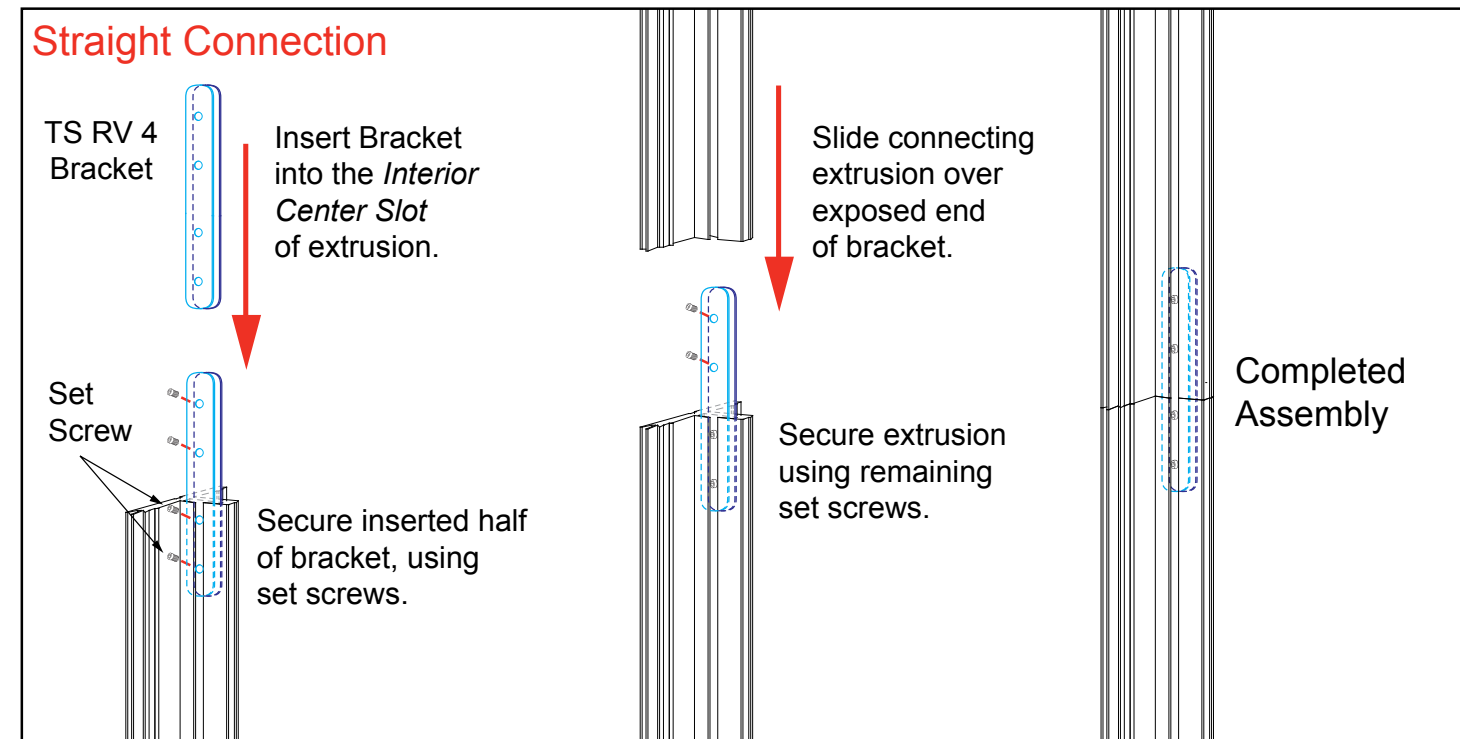

Corner Bracket Installation

- 1) Slide TWO-PIECE **TS RV 2** L-bracket into Interior Center Slot of extrusion so that two set screws are inside groove. Tighten two set screws to secure.
- 2) Slide one A1 L-Bracket into outer interior grooves of upper and lower horizontals. Tighten set screws to secure.
- 3) Slide vertical extrusion over exposed ends of brackets in lower horizontal. Tighten set screws to secure.
- 4) Slide exposed ends of installed brackets of upper horizontal into open ends of verticals. Tighten set screws to secure.

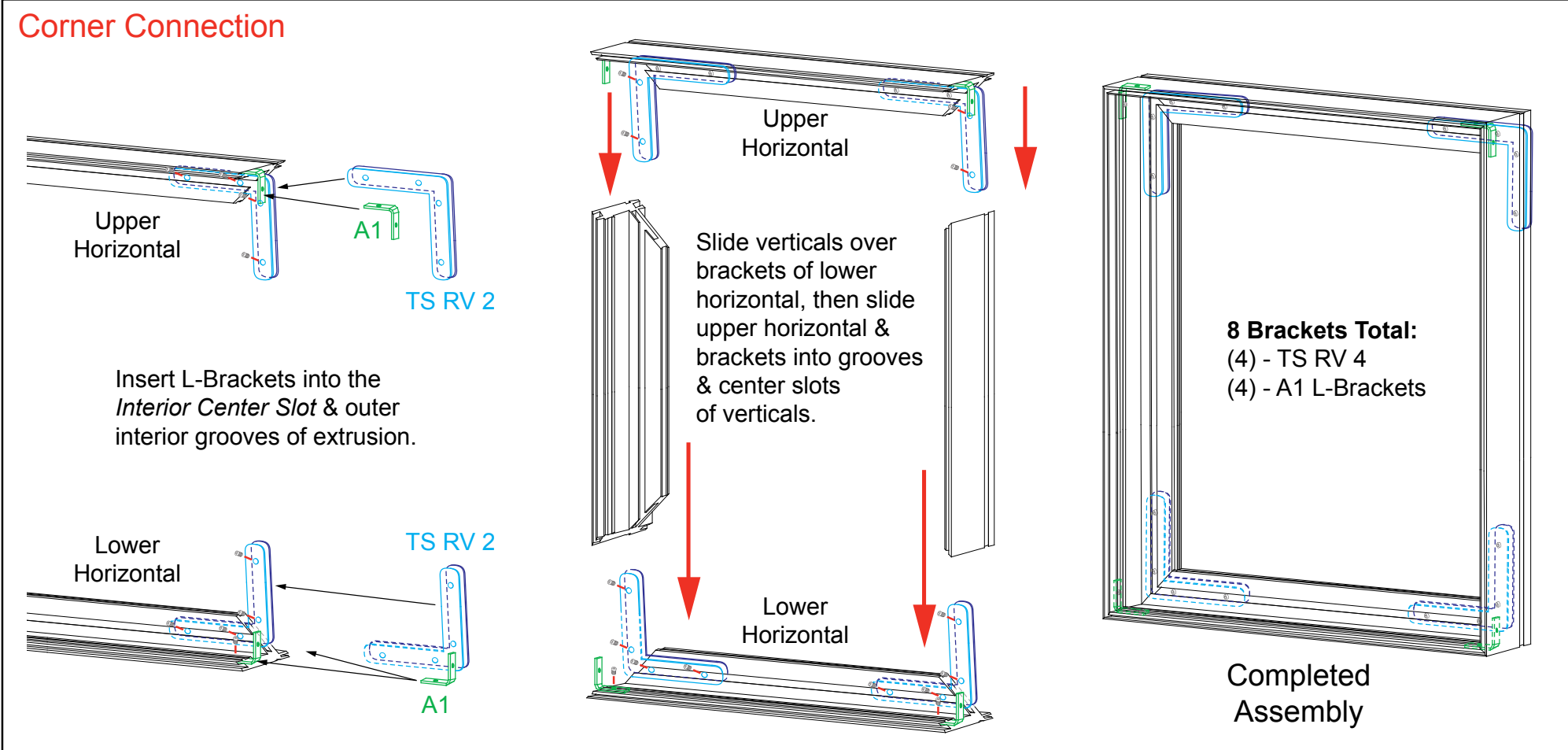

Disassembly

- 1) Loosen set screws on brackets, then slide extrusions off of brackets.

Top View of Each Level

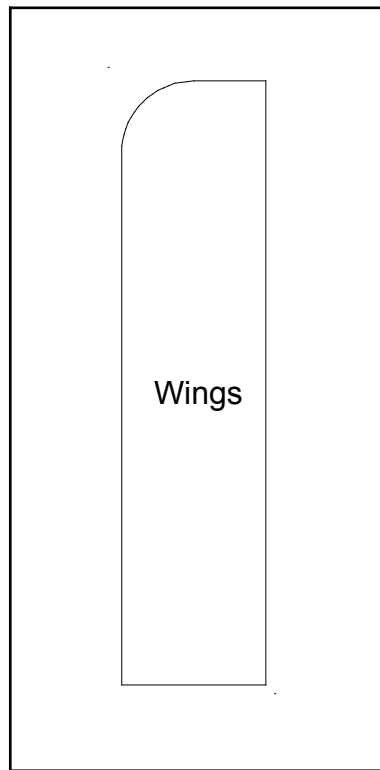

Level 1

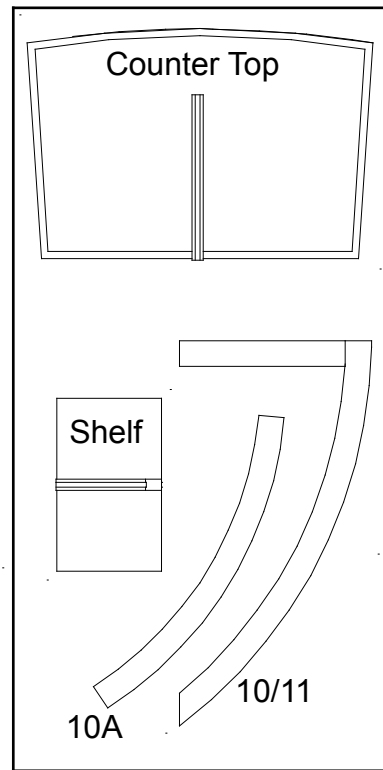

Level 2

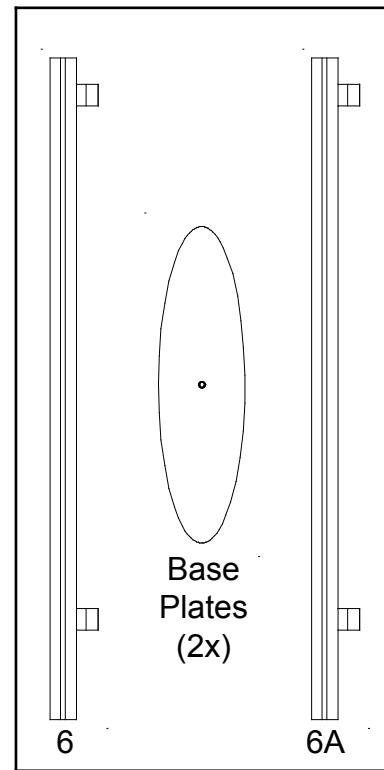

Level 3

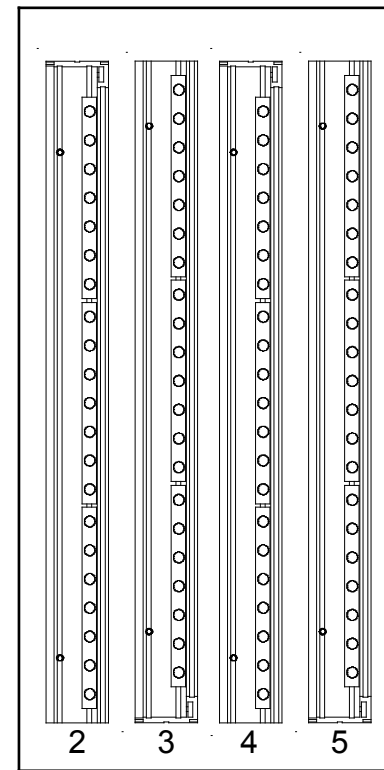

Level 4

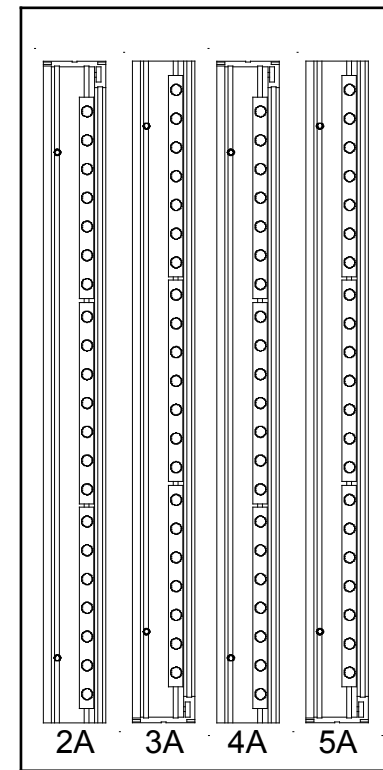

Level 5

Top View of Each Level

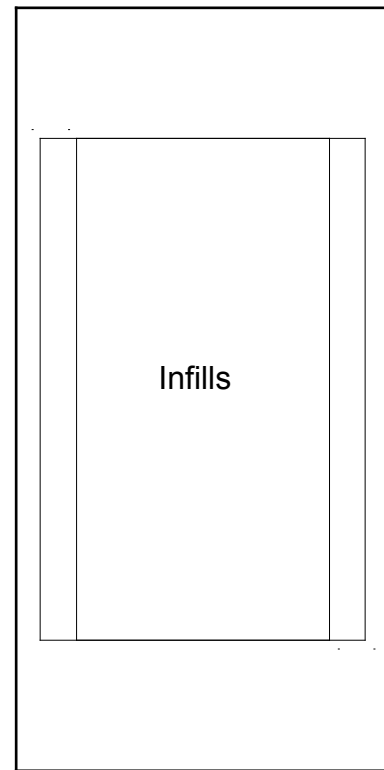

Level 1

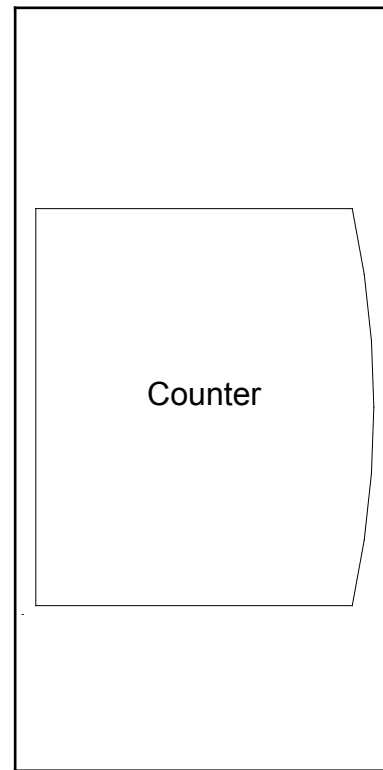

Level 2

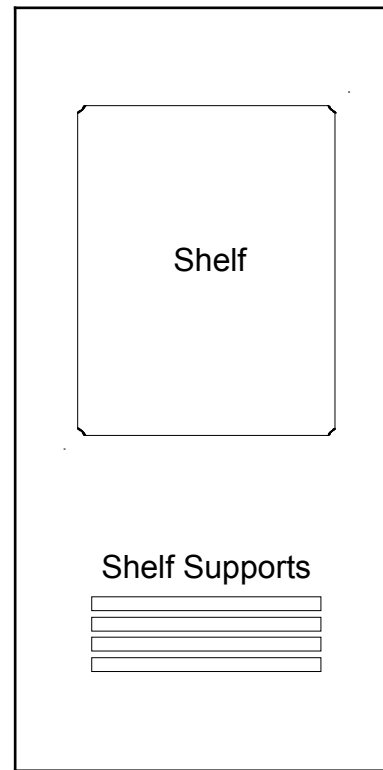

Level 3

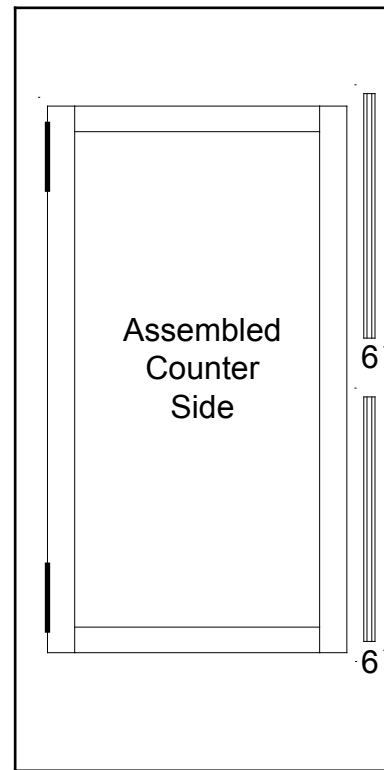

Level 4

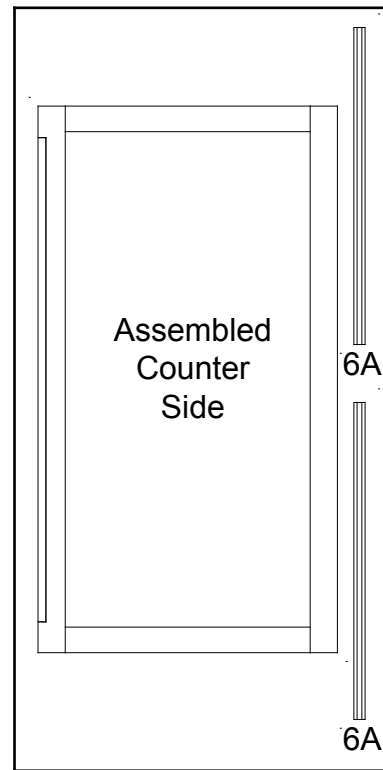

Level 5

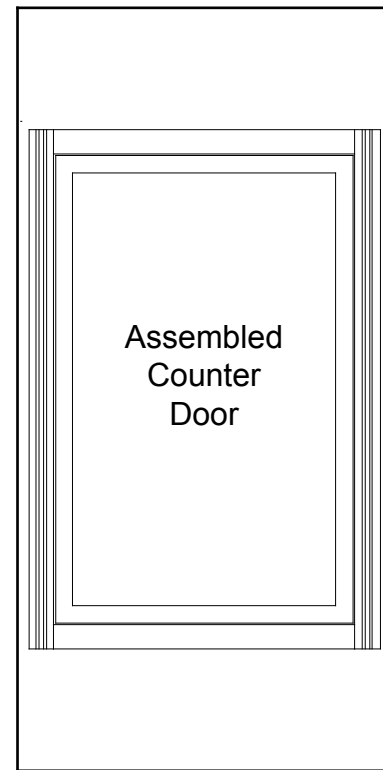

Level 6

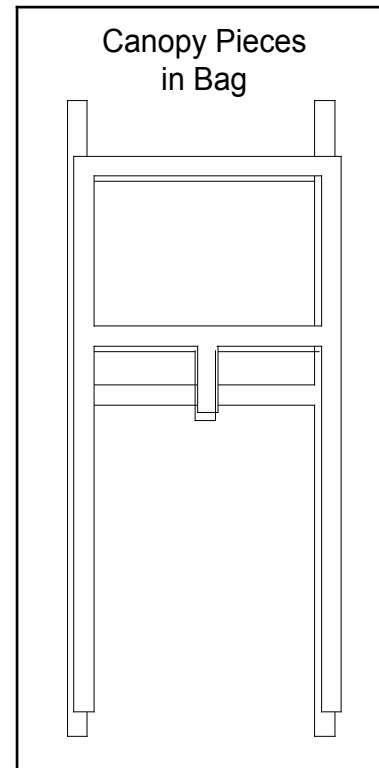

Level 1

Graphics

Literature Holders
& Monitor Mount

Setup Hardware

Item	Qty.	Description
1	2	Base Plate
2/2A	1/1	46" CEI-110 Horizontal Extrusion
3/3A	1/1	46" CEI-110 Horizontal Extrusion
4/4A	1/1	46" CEI-110 Vertical Extrusion
5/5A	1/1	46" CEI-110 Vertical Extrusion
6/6A	1/1	46" S44 Vertical Extrusion

- Steps:
- 1) Attach Base Plates [1] to lower Vertical Extrusions [2] and [3], using bolts.
 - 2) Connect Horizontal Extrusions [2,2A] [3,3A] and Vertical Extrusions [4,4A] [5,5A] together, then connect Extrusion assemblies together at corners. See CEI-110 Assembly page for details.
 - 3) Connect Lights and Transformers. See **Light to Light Connection** and **Light to Transformer Connection** details.
 - 4) Connect Vertical Extrusions [6] and [6A] together, using Connector. See **Extrusion Connector** detail.
 - 5) Connect [6/6A] assembly to [4/4A] assembly, using Bolts. See **S44 to CEI-110 Connection** detail.
 - 6) Install SEG Graphic to front of Backwall. See **SEG Graphic Installation** detail.

SEG Graphic Installation

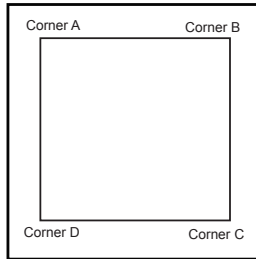

It is important to first insert graphic into each alternate corner then to the sides of the frame. If this is not done, graphic will not fit into the frame correctly.

Step 1
Insert corner A. Turn edge of graphic so silicon welt is perpendicular to face of graphic. Insert narrow side of welt with fabric to outside into the channel. Repeat for other side of this corner.

Step 2
Repeat Step 1 for opposite corner C, then insert corner D, to complete the installation of the corners.

Graphic Removal



Step 3
Once all corners are inserted, press one silicon edge into channel from corners and work toward the center. Make sure welt is fully inserted into channel. Continue until all sides are done. Smooth out edges of graphic.

To remove the graphic from the frame, locate the fabric pull tab. Gently pull up on the tab to remove the fabric.

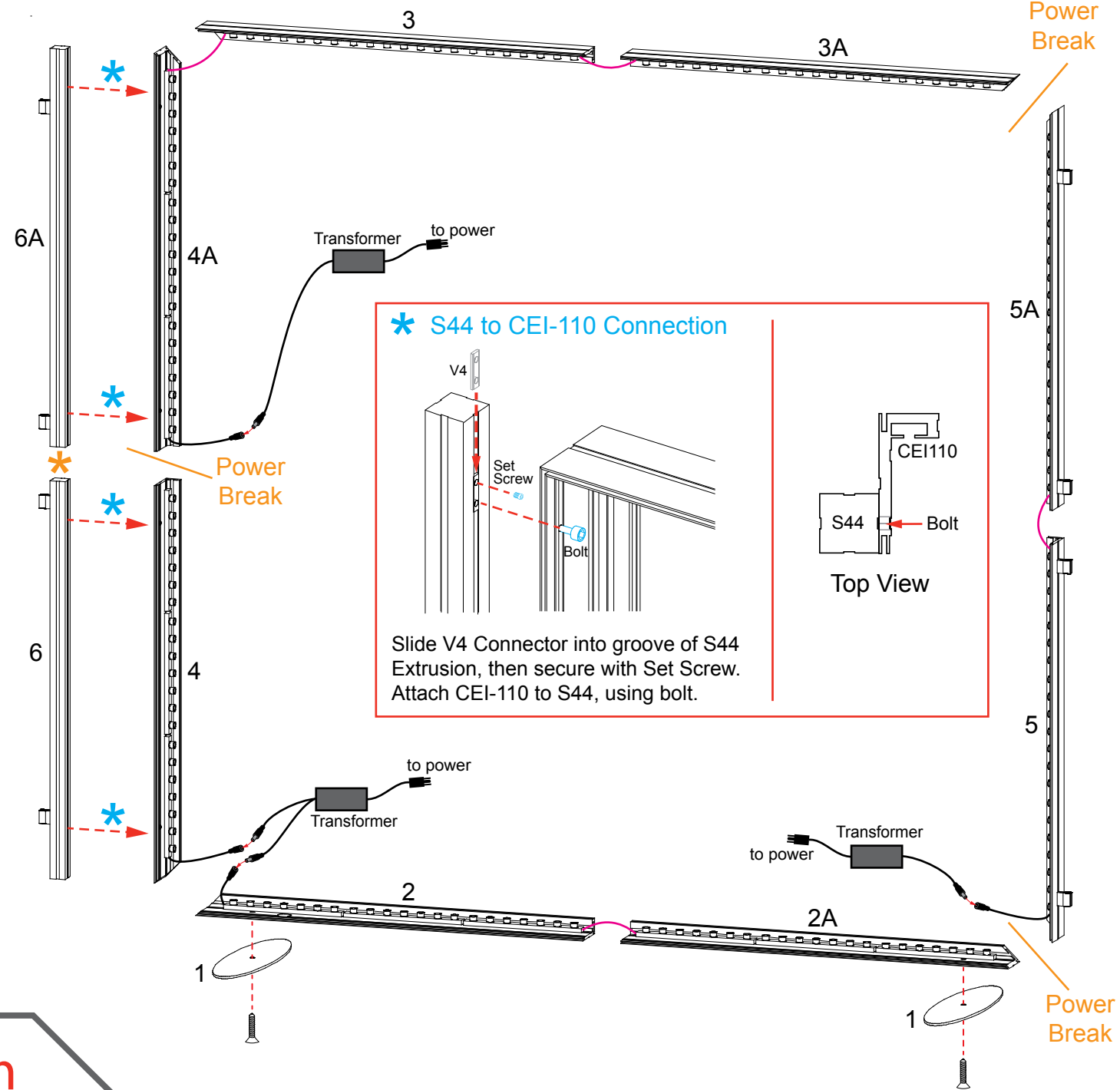

Light to Light Connection

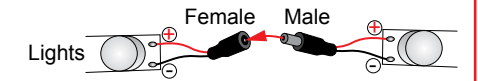

Light to Transformer Connection

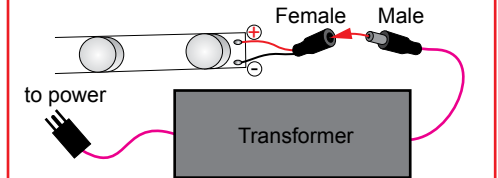

Lighting Installation Warning

If utilizing your own hardware, purchase **Nylon Washers** to prevent metal screw heads from damaging the circuit board. Attach no more than **seven** lights per chain.

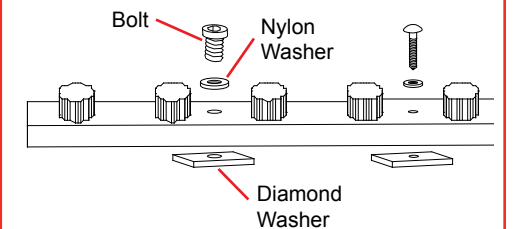

* Extrusion Connector

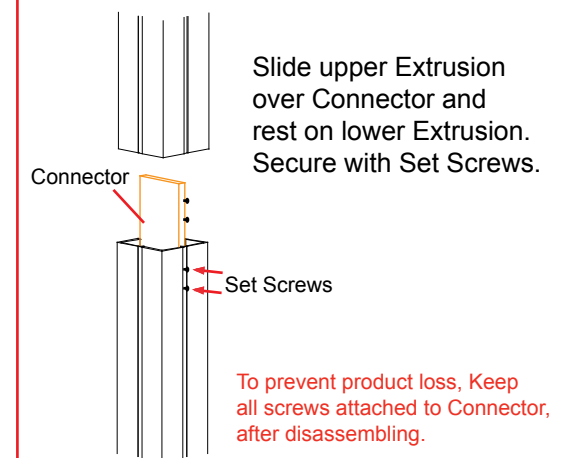

AERO

Using Your Setup Instructions

The Aero Overhead Sign Setup Instructions are created specifically for your configuration. They include an exploded view of the frame which is sequentially numbered. We encourage you to study the instructions before attempting to assemble your exhibit.

Connections are kept very simple: no tools. Everything assembles with push-button connectors and pre-connected horizontal sections.

Cleaning and Packing Your Display

- 1) Use care when cleaning aluminum extrusion or acrylic inserts. Use only non-abrasive cleaners.
- 2) Retain all packing material. It will make re-packing much easier and will reduce the likelihood of shipping damage.

Steps:

- 1) Connect canopy pieces together as shown.
- 2) Apply pillow case graphic to assembled canopy.

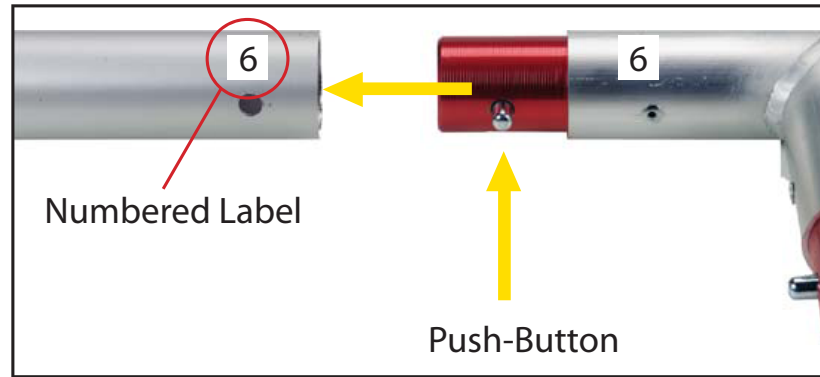

Connections are made by holding the button down and sliding the red tube into opposing tube until the connection is made. To disassemble push button and pull or twist extrusions apart.

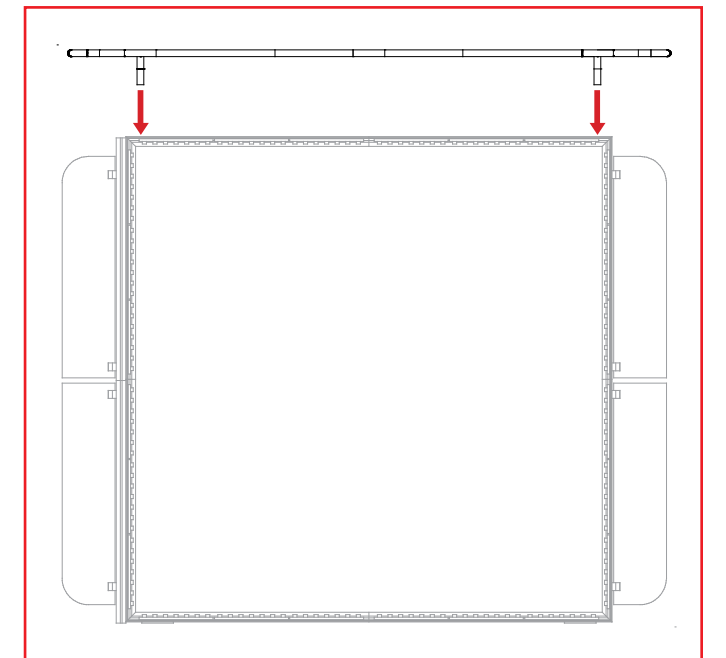
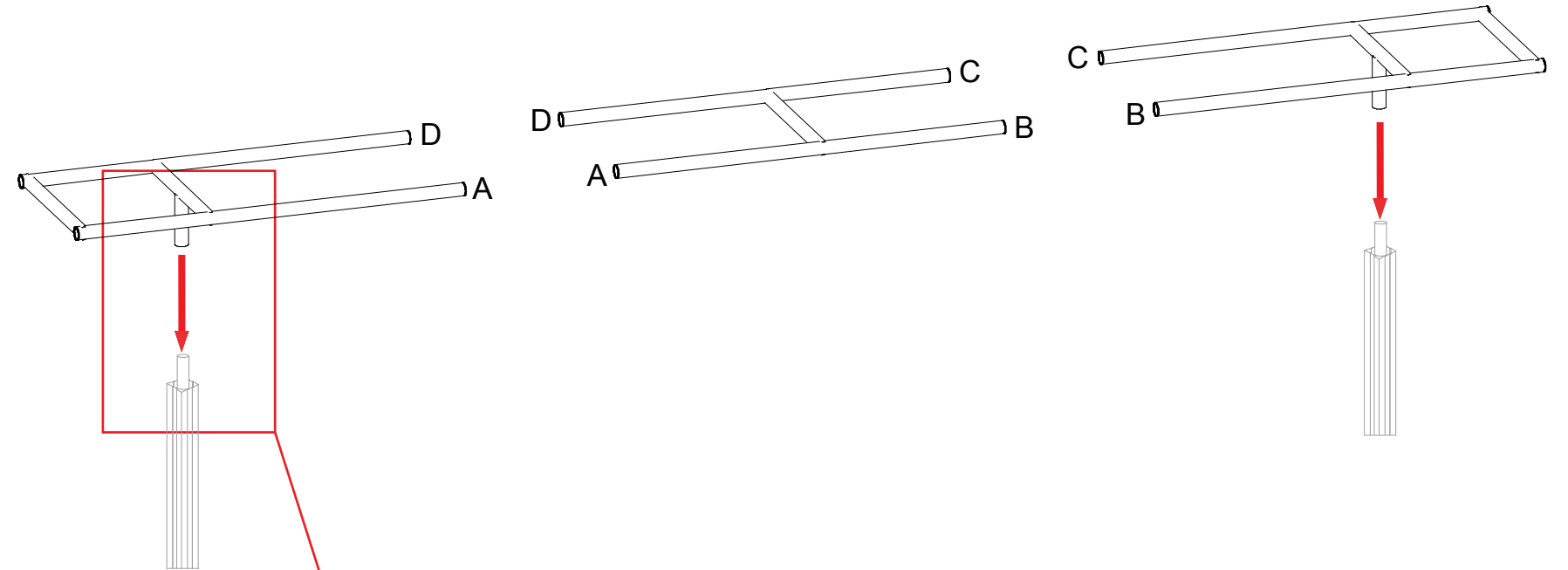
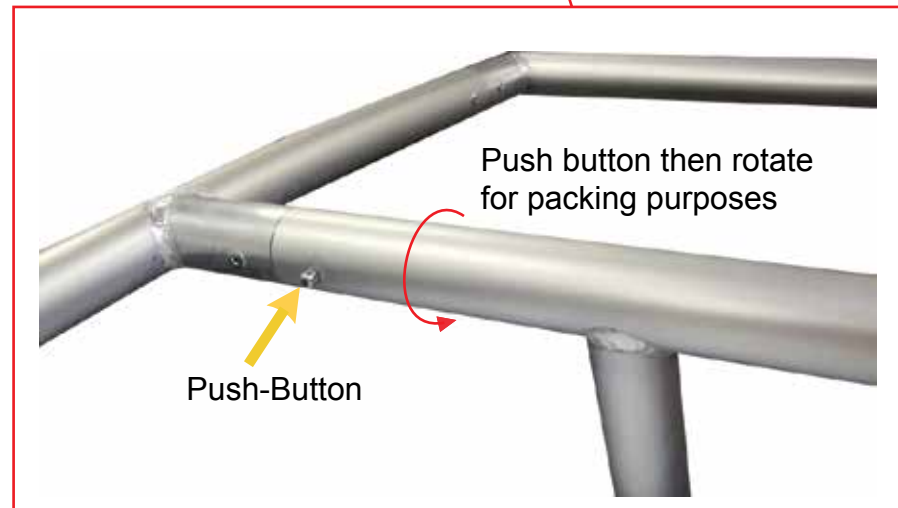
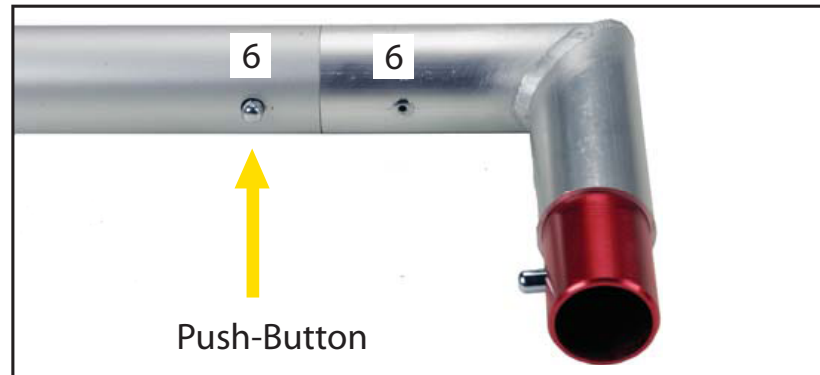

Steps:

- 1) Connect assembled Counter Top support [10,11] to Vertical [4].
- 3) Connect Support Leg [10A] to Counter Top support [10,11].
- 4) Attach Flange Plates [11A] to top of Curved Extrusions [10], using screw.
- 5) Attach Counter Tops to supports [11/11A]. See **Counter Top Attachment** detail.
- 6) Attach **Wings** to A10 Clamps. See **A10 Clamp** detail.
- 7) Attach assembled Canopy to top of Horizontal assembly [3/3A].
- 8) Attach Monitor Mount to Vertical Extrusion [4A], using Connectors.
See **Monitor Mount** detail.

Item	Qty.	Description
10	2	30.2" Z45 Curved Extrusion
10A	2	Support Leg
11	2	12.184" Z45 Horizontal Extrusion
11A	2	Flange Plate

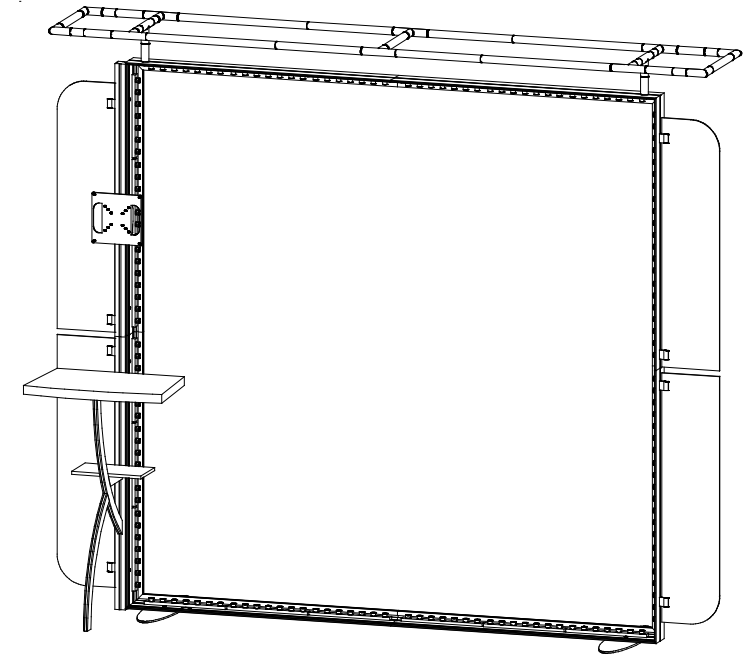

Completed VK-1965 Assembly
(Front View)

A10 Clamp

- 1) Slide Connector of Clamp into extrusion groove.
- 2) Tighten set screw when A10 is in desired location.
- 3) Insert Wing into Clamp.
- 4) Tighten knob on Clamp to secure Wing in place.

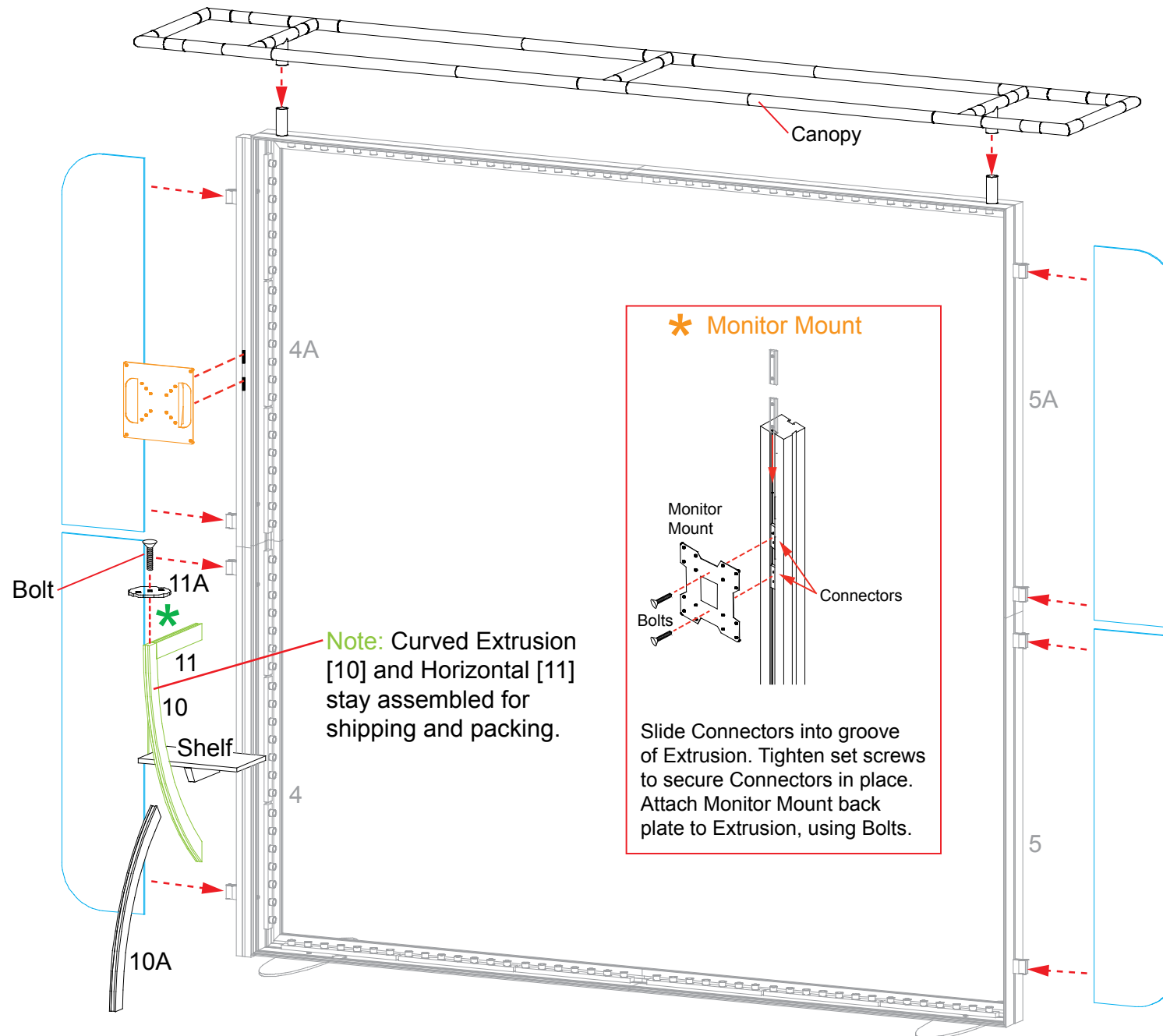

*** Counter Top Attachment**

Insert Screws, located on underside of Counter Top, into holes on Flange Plate then secure with Wing Nuts.

Item	Qty.	Description
1	1	38" RSG520 Vertical Extrusion
2	1	38" RSG520 Vertical Extrusion
3	1	38" RSG520 Vertical Extrusion
4	1	38" RSG520 Vertical Extrusion
5/5A	2/2	17" Z45 Horizontal Extrusion
6/6A	1/1	22" Z45 Horizontal Extrusion

Steps:

- 1) Connect lower horizontals [5] & [6] between verticals [1,2,3,4].
- 2) Place **Infills** between verticals [1,2,3,4], with Velcro facing inward.
- 3) Connect **Shelf Supports** to Velcro inside of Infills, then place Shelf on top of Shelf Supports.
- 4) Attach door using hinges. See **Door Connection** detail.
- 5) Attach upper horizontals [5A, 6A & 7A] between verticals.
- 6) Place Counter on top of assembly, then lock in place. See **Counter Top Attachment** detail.
- 7) Attach Literature Holders to Verticals [3] and [4]. See **Literature Holder Attachment** detail.

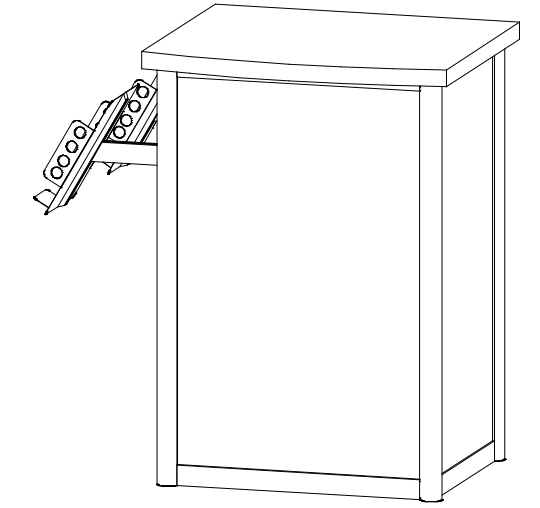
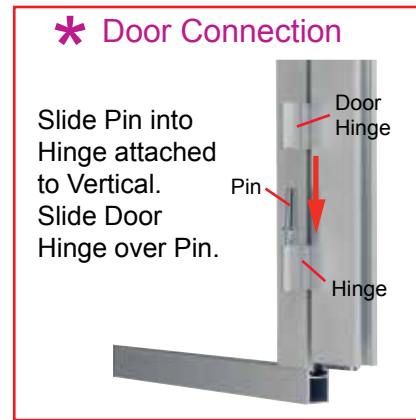

Completed Assembly (Front View)

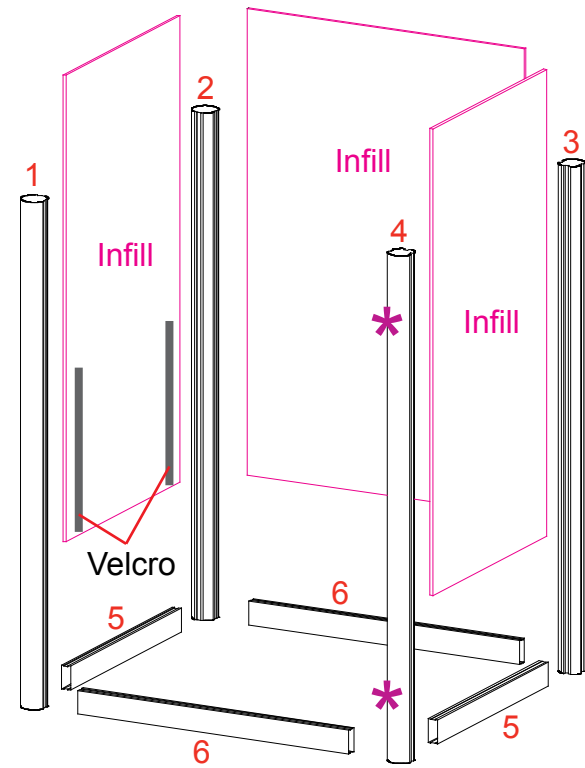

Counter Assembly (Back View)

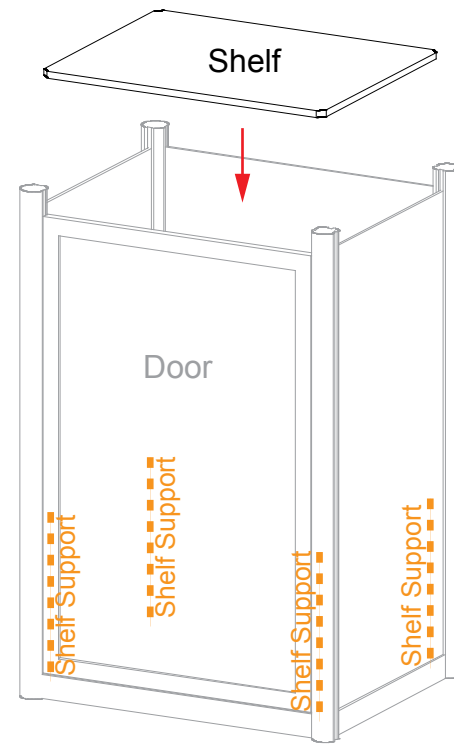
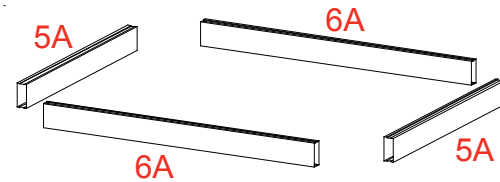

Counter Assembly (Back View)

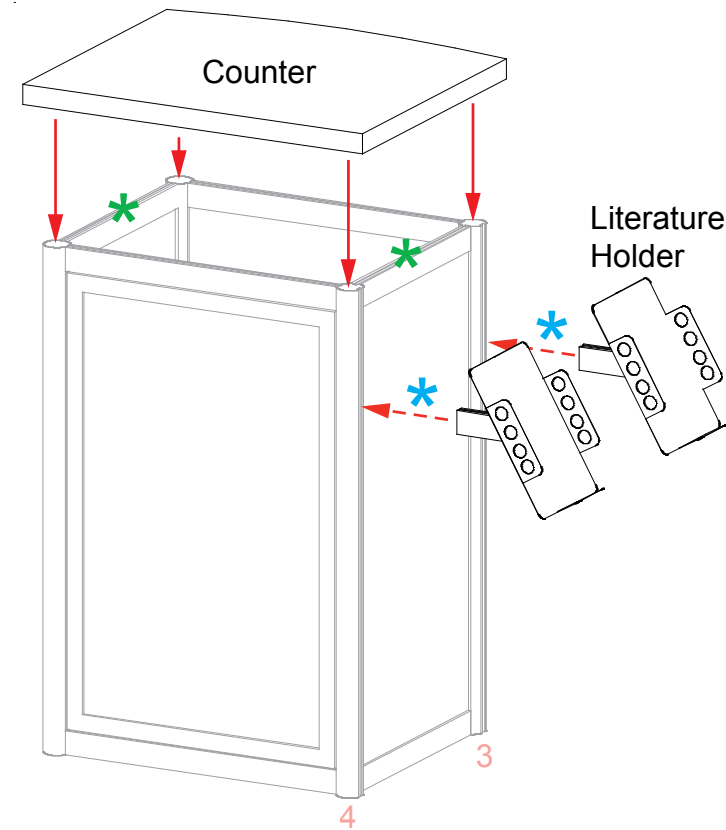

Counter Attachments (Back View)

